



For immediate release

News media contact: Leslie Braunstein  
(202) 656-0542 - [info@lhbcommunications.com](mailto:info@lhbcommunications.com)

## Grand Opening for Solaire 8250 Georgia Avenue Apartment Building Set for November 6, 2019

*Washington Property Company's Latest Downtown Silver Spring Luxury  
Residence is Over 60 Percent Leased*

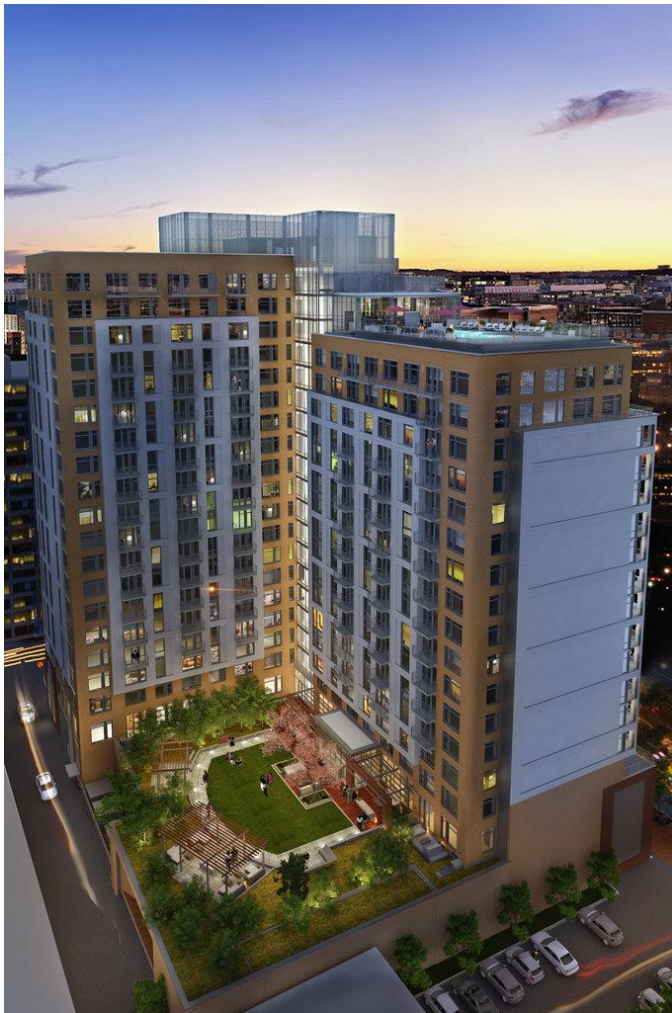

(Bethesda, MD, October 30, 2019)—  
**Washington Property Company (WPC)** will welcome the downtown Silver Spring, MD community on November 6, 2019 for a grand opening of its latest luxury apartment community, Solaire 8250 Georgia Avenue. This 20-story, amenity-rich 338-unit residence is located just two blocks from the Silver Spring (MD) Metro and multi-modal transit station.

The grand opening event will be held from **5:00 to 6:30 pm on Wednesday, November 6**, and will feature tours of the studio, one- and two-bedroom apartments. Visitors also will be able to see the building's resort-style rooftop swimming pool, private courtyard with grilling areas, state-of-the-art fitness center; and expansive residents' club room with catering kitchen, library, flat-screen TV, indoor-outdoor fireplace, and game room.

WPC has leased over 60 percent of the building and is accepting applications for the remaining apartment homes. Information can be found at <https://solaire8250.com/>. KETTLER provides leasing and property management services for Solaire 8250 Georgia Avenue.

Solaire 8250 Georgia Avenue is WPC's fourth Solaire-branded apartment community and its second in Silver Spring's rapidly evolving Ripley District. WPC plans to break ground early next year on a fifth Solaire-branded tower, slated to be the tallest building in Silver Spring.

WPC's five completed Solaire communities will total over 1,400 units, combining the finest amenities and high-end finishes with close proximity to Metrorail's Red Line. Solaire-Metro, located just two blocks from Solaire 8250 Georgia Avenue, opened in 2012; Solaire Wheaton delivered in 2014; and Solaire Bethesda delivered in late 2016.

The 338 apartments at Solaire 8250 Georgia Avenue offer stylish, contemporary features such as quartz countertops, stainless steel appliances, fine cabinetry, wood flooring, large windows and private balconies. The building is designed to achieve LEED Silver certification.

"Our latest addition to downtown Silver Spring living is a transformative project that will activate the streetscape with 15,000 square feet of new retail space and serve as a gateway to the vibrant Ripley District," said WPC's Janel Kausner, Vice President of Development. "With its commanding presence, inspiring architecture, and emphasis on refined finishes for modern urban living, Solaire 8250 Georgia Avenue will establish downtown Silver Spring as a destination of choice."

**Washington Property Company** ([www.washproperty.com](http://www.washproperty.com)) is a full-service commercial real estate company located in Bethesda, Maryland. Established by Charles K. Nulsen, III, WPC is involved in a full range of real estate investment services including acquisition, land use, development, property management, leasing, and construction management. WPC has developed more than eight million square feet of commercial space in the Washington, DC metropolitan area and currently has over 1.6 million residential square feet under development. WPC is actively pursuing office, multi-family, retail, and mixed-use development opportunities throughout the region. Through its management company, WPC Management, LLC, Washington Property Company manages over 1.8 million square feet of commercial space.